

GameStop AX-1250 WIRELESS HEADSET USER GUIDE

Need Help?

Have any questions or comments? Need help getting set up? Contact us at <https://care.gamestop.com>

What's Included

- Wireless Console Headset
- 5.8Ghz Dongle
- USB-C to USB-A Charging Cable
- 3.5mm TRRS Aux Cable

LED Indicators

- Headset/Dongle Indicator Flashing Blue - Unpaired
- Headset Indicator Rapidly Flashing Blue - Pairing
- Solid Blue Light - Paired
- Headset Indicator Solid Red - Charging

Connection Types

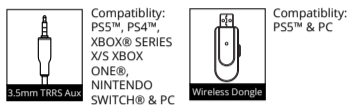

Pairing the Headset

- Insert the included 5.8Ghz dongle into the USB port of a compatible device.
- Hold the power button on the headset for 3 seconds to turn it on and off.
- The headset will automatically pair with dongle when it is plugged into your console.
- Having trouble connecting? See the troubleshooting section on the back side.

Charging the Headset

- Plug the USB-C end of the charging cable into the headset.
- Plug the USB-A end of the charging cable into a UL compliant power supply of at least DC 5V 800mA.
- A full charge requires approximately 4 hours. The red light will turn off when charging is complete. Note: The headset cannot be used wirelessly while charging. To resume wireless use, disconnect the charger once battery is fully charged. Alternatively, you can listen to the audio while its charging by using the equipped AUX cable.

PS5 Setup

- Plug the 5.8Ghz receiver into the USB port located on the front of your console and power on the headset.
- You can also use the included 3.5mm Aux cable to connect by plugging the headset into the controller.
- Enter the settings menu > Sound > Audio output > Output device > "select the headset plug in".
- Set input and output device to USB Headset.
- Set headphone volume level to your desired setting.
- Select the microphone level and follow the prompts to adjust your desired settings.

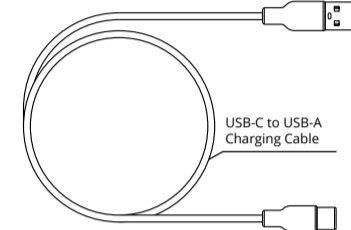
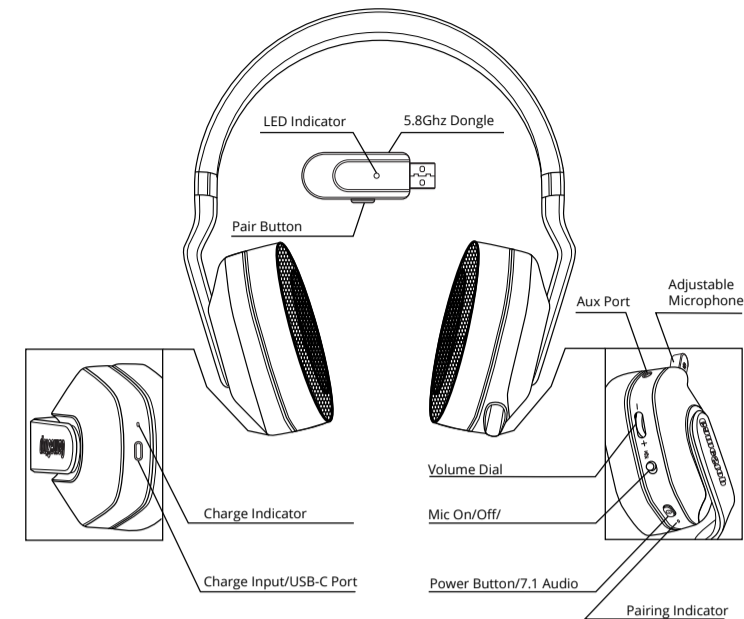

PS4 Setup

- Plug the 5.8Ghz receiver into the USB port located on the front of your console and power on the headset.
- You can also use the included 3.5mm Aux cable to connect by plugging the headset into the controller.
- Set headphone volume level to your desired setting.
- Select the microphone level and follow the prompts to adjust your desired settings.

XBOX Series X/S Setup

- Use the AUX cable to plug the headset into the controller. Note: Not all controllers will have a 3.5mm audio jack.
- Enter the Setting Menu > General Settings > audio output > other options > mute driver in display.
- Set Headset Volume to your desired setting.
- Set Mic Monitoring to your desired setting.

XBOX One Setup

- Use the AUX cable to plug the headset into the controller. Note: Not all controllers will have a 3.5mm audio jack.
- Enter the Setting Menu > General Settings > audio output > other options > mute driver in display.
- Set Headset Volume to your desired setting.
- Set Mic Monitoring to your desired setting.

PC Setup

- Plug the 5.8Ghz receiver into an audio enabled USB port on your PC and power on the headset.
- Set audio input and output to USB connected device.
- If you're having problems make sure the USB device is selected for default communications in sound control settings.

7 Inches

FRONT

6.25 Inches

GameStop AX-1250 WIRELESS HEADSET USER GUIDE

Switch Setup

- Use the AUX cable to plug the headset into the switch.
- The switch must be used out of the dock in handheld mode to use the audio jack.

Adjusting The Mic

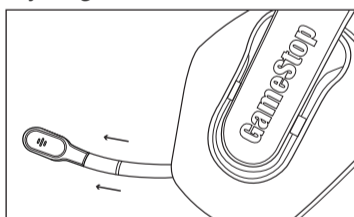

- The microphone is adjustable and can be extended or pushed back into the headset.
- To adjust the microphone pull it out of the ear cup, do not pull too hard to avoid damaging it.

7.1 Audio Setup

- For console: Press the power button after the headset is turned on and paired.
- For PC: For 7.1 enhanced audio driver use the qr code or navigate to <https://www.gemsfindyours.com/atrix-ax-1250-wireless-headset> and download the zip file. Then follow the easy steps:
 1. Extract the zip file contents to a folder on your computer
 2. Plug your headset into your PC
 3. Run the 'Setup.exe' and follow the prompts.
 4. Press the power button after the headset is turned on and paired.



Troubleshooting

1. Having issues with pairing? Follow the steps below to re-establish pairing with the dongle and headset.

If the connection is broken:

- Make sure the headset is turned off.
- Insert the dongle into the USB port.
- Press and hold the dongle 'Pair Button' for 6 seconds until the blue light flashes rapidly and then let go.
- On the headset, press and hold the 'Power Button' for a few seconds until the dongle LED turns solid. The headset is now paired.

2. If you are having issues where your audio seems to drop intermittently or there is buzzing or feedback in the ear cups you may be experiencing interference. These headsets are designed to use the 5.8Ghz wireless range. Many other devices such as wifi routers, smart thermostats and wireless speakers may also be using this frequency in your home and causing interference. Here are some options to reduce the chance of interference:

3. This headset cannot be used with XBOX wirelessly, to play using an XBOX follow the instructions above.

A. Reduce the number of nearby wireless devices in your gaming area.

B. Maintain line of sight with the dongle and your headset if possible, sometimes simply moving the dongle to the front of your console or PC can reduce the amount of noise allowed to interfere.

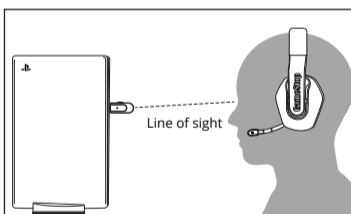

C. Try temporarily disconnecting your wifi or unplugging it and then play a game offline to see if the issue still persists.

D. Try and maintain at least a 5ft distance of a wifi router or satellite router from the dongle/gaming area.

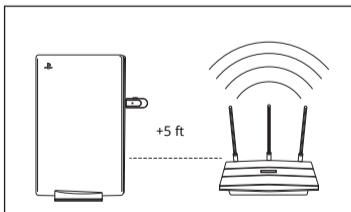

E. If your router can operate on both 2.4 or 5 GHz try selecting only 2.4GHz so the 5.8GHz can be clear for the headset.

G. Ensure the dongle is directly connected into the console or PC without the use of an extension cable or monitor USB ports.

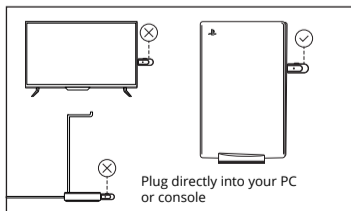

H. Keep other USB devices away from the dongle if possible to improve signal strength ports.

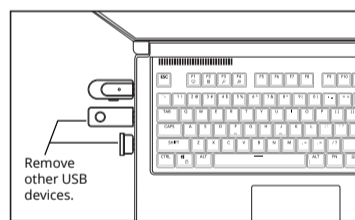

Headset FCC ID: 2A023-GSHP57 IC: 26424-GSHP57 Input: DCSV #=800mA
Dongle FCC ID: 2A023-GSHP57C IC: 26424-GSHP57C Model: GSHP57 Input: DCSV #=300mA

IMPORTANT SAFETY INSTRUCTIONS
WARNING: When using this product, basic precautions should always be followed, including the following:
Protect equipment from humidity.
Do not use chemical detergents to clean your device, use a soft dry cloth.
To avoid damage from electrical peaks unplug the device when it is not in use.
If one of the following situations arise, equipment has to be checked by qualified service personnel:
• Liquid has penetrated into the equipment.
• Equipment has been exposed to humidity.
• Equipment has been dropped and/or is damaged.
• Equipment has obvious sign of breakage.
• Equipment does not work well or you cannot get it working according to user's manual.

SAVE THESE INSTRUCTIONS:
This device complies with Part 15 of the FCC Rules. Operation is subject to the following two conditions:
1) This device may not cause harmful interference.
2) This device must accept any interference received, including interference that may cause undesired operation.
WARNING: Changes or modifications to this unit not expressly approved by the party responsible for compliance could void the user's authority to operate the equipment.

NOTE: This equipment has been tested and found to comply with the limits for a Class B digital device, pursuant to Part 15 of the FCC Rules. These limits are designed to provide reasonable protection against harmful interference in a residential installation. This equipment generates, uses and can radiate radio frequency energy and, if not installed and used in accordance with the instructions, may cause harmful interference to radio communications. However, there is no guarantee that interference will not occur in a particular installation. If this equipment does cause harmful interference to radio or television reception, which can be determined by turning the equipment off and on, the user is encouraged to try to correct the interference by one or more of the following measures:
• Reorient or relocate the receiving antenna.
• Increase the separation between the equipment and receiver.
• Connect the equipment into an outlet on a circuit different from that to which the receiver is connected.
• Consult the dealer or an experienced radio/TV technician for help.

Made in China
ASSISTANCE:
For questions or assistance, please contact GameStop Customer Service at 1 (800) 863-8895 or care@gamestop.com.

7 Inches

BACK

